

# Door Coupling Details



## System 4-45 Hi+

CASEMENT WINDOW

The fabricator must ensure that the window/door design and coupling mullion details can adequately accommodate the anticipated expansion and contraction required for the applicable configuration. For advice please contact Metal Technology's Technical Department.

For advice on horizontal coupling, refer to Metal Technology's Technical Department.

Door outer frames to be screw fixed to coupling mullion as indicated on "Coupling Mullion Prep Details" sheets in System 5-35D manual. Coupling mullion to be lug fixed back to structure at head and cill using plates/straps (by fabricator) fixed to integral screwports within coupling profile. Metal Technology recommend that the coupling mullion be secured to the outer frame, as indicated prior to installation on site. Windows to be screw fixed to coupling mullions at 600mm centres as indicated. Where possible fixings should be staggered/offset.

All fixings must be sealed using HR50328A or alternative suitable sealant.

† If a different outer frame is used, the fabricator must determine an alternative fixing detail.

\* Ensure adequate clearance to accommodate opening sash, butt hinges, etc.

### COUPLING TO OPEN IN SYSTEM 5-35D Hi+ DOOR

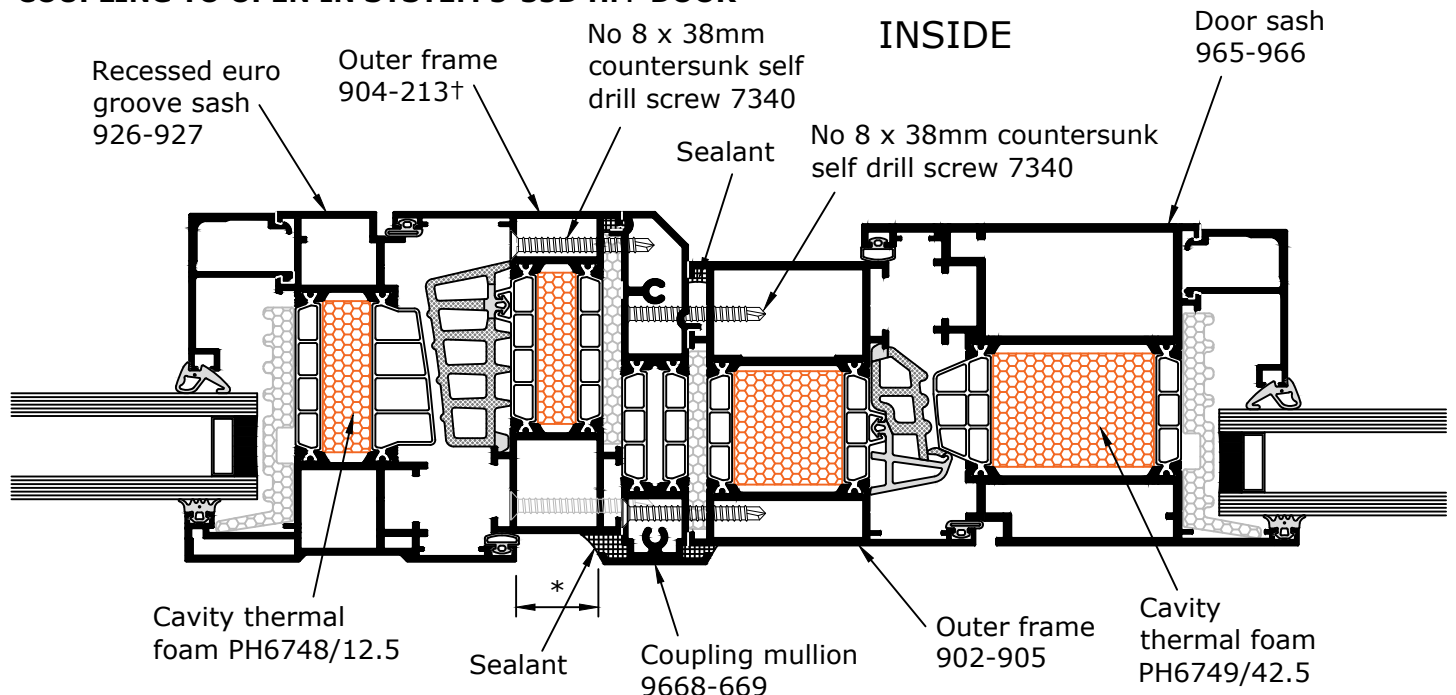

### COUPLING TO OPEN OUT SYSTEM 5-35D Hi+ DOOR

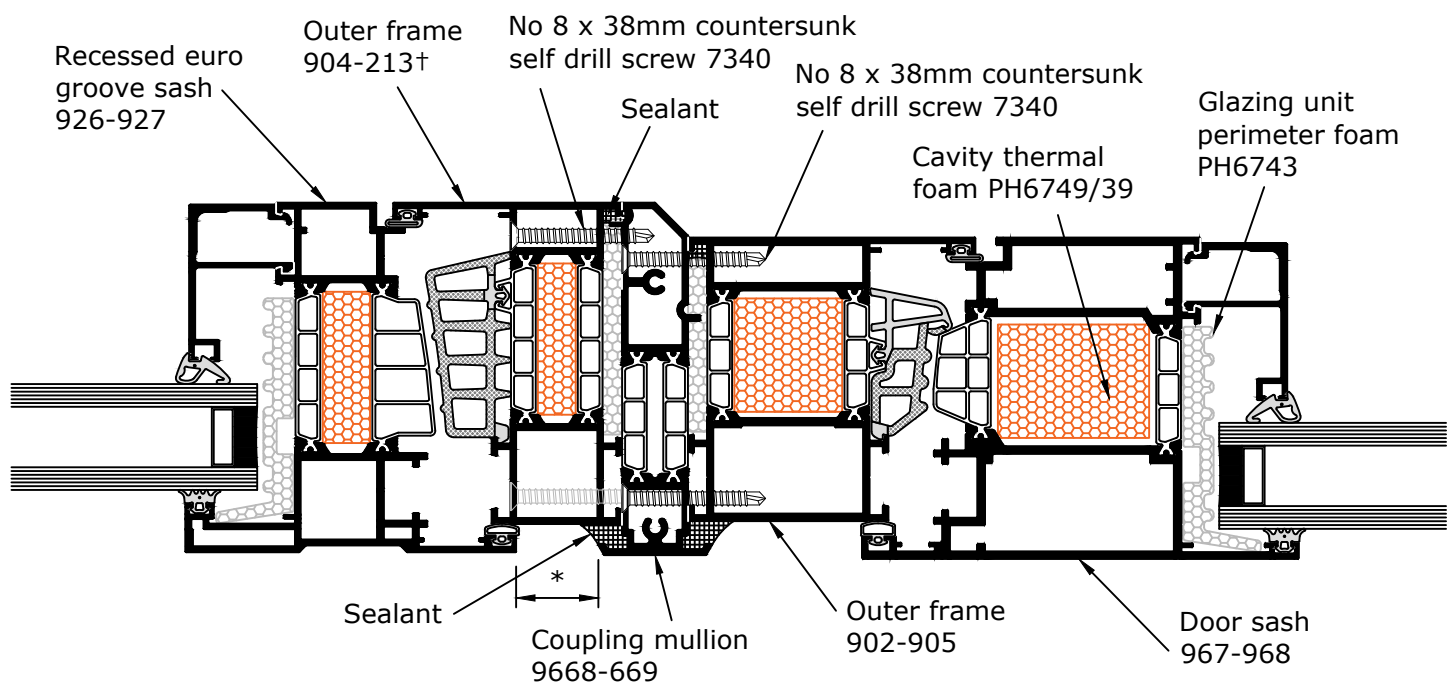

Scale 1:2

OUTSIDE